

NOTE: THESE DRAWINGS ARE TO BE USED EXCLUSIVELY FOR ACQUISITION OF REGULATORY PERMITS.

REVISED: 10/27/2023 03/10/2025
11/15/2023 04/11/2025
01/15/2025

SECTIONS 12, 13, 14, 23, 26 & 35 T11S - R13W
SECTION NULL T12S - R14W

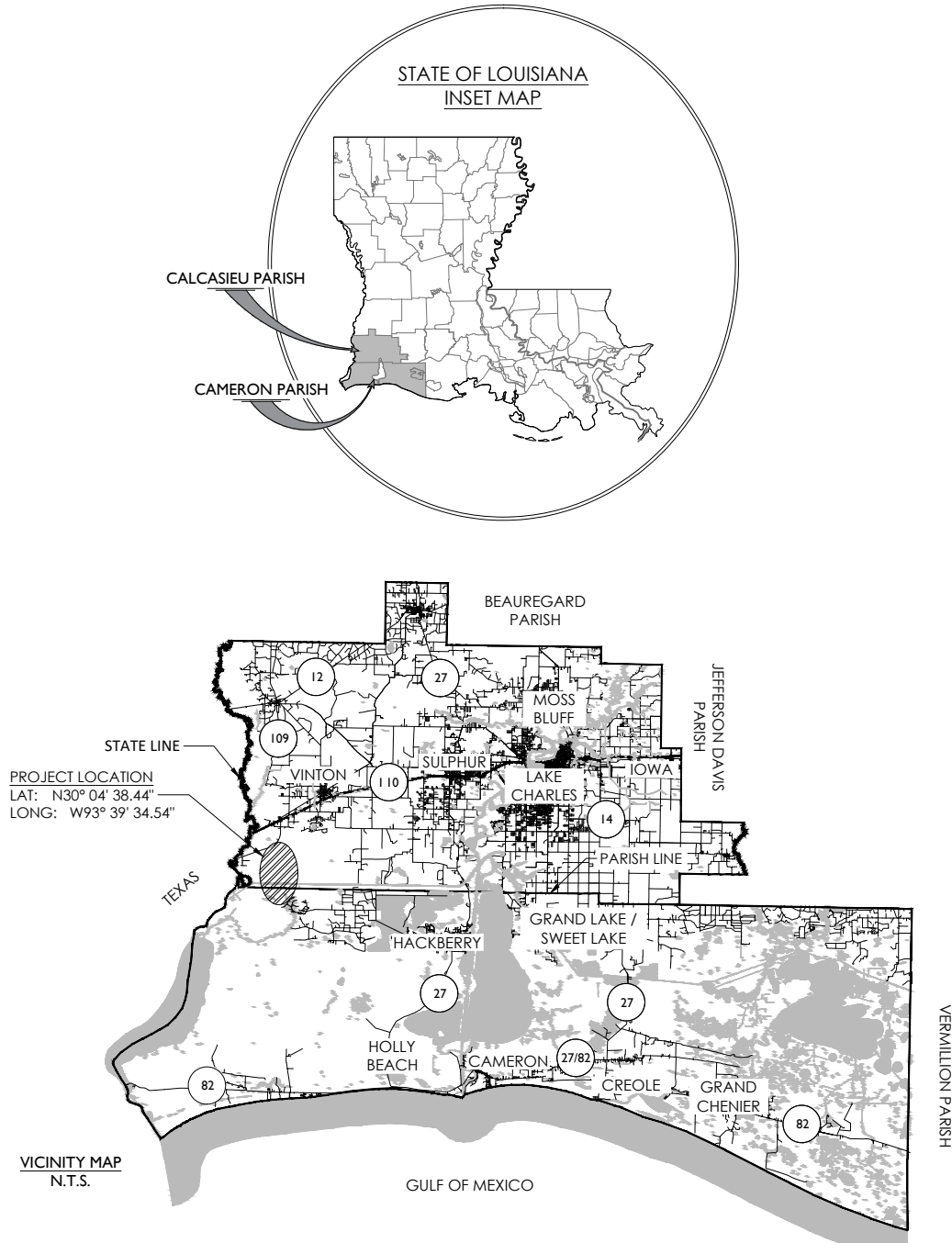

PREPARED BY:

K&M PROJECT SERVICES, LLC



K&M Project Services, LLC
1000 Country Club Road
Phone: (337) 508-2868

MINERVA WELL-SITE ACCESS ROUTES

CALCASIEU PARISH, LOUISIANA
CAMERON PARISH, LOUISIANA

APPLICATION BY: Tetra Tech
PROJECT NO.: 2023-046

TITLE SHEET

SCALE: AS SHOWN

DATE: 08/11/2023

DRAWN BY: BML

01
16

NOTE: THESE DRAWINGS ARE TO BE USED EXCLUSIVELY FOR ACQUISITION OF REGULATORY PERMITS.

REVISED: 10/27/2023 03/10/2025
11/15/2023 04/11/2025
01/15/2025

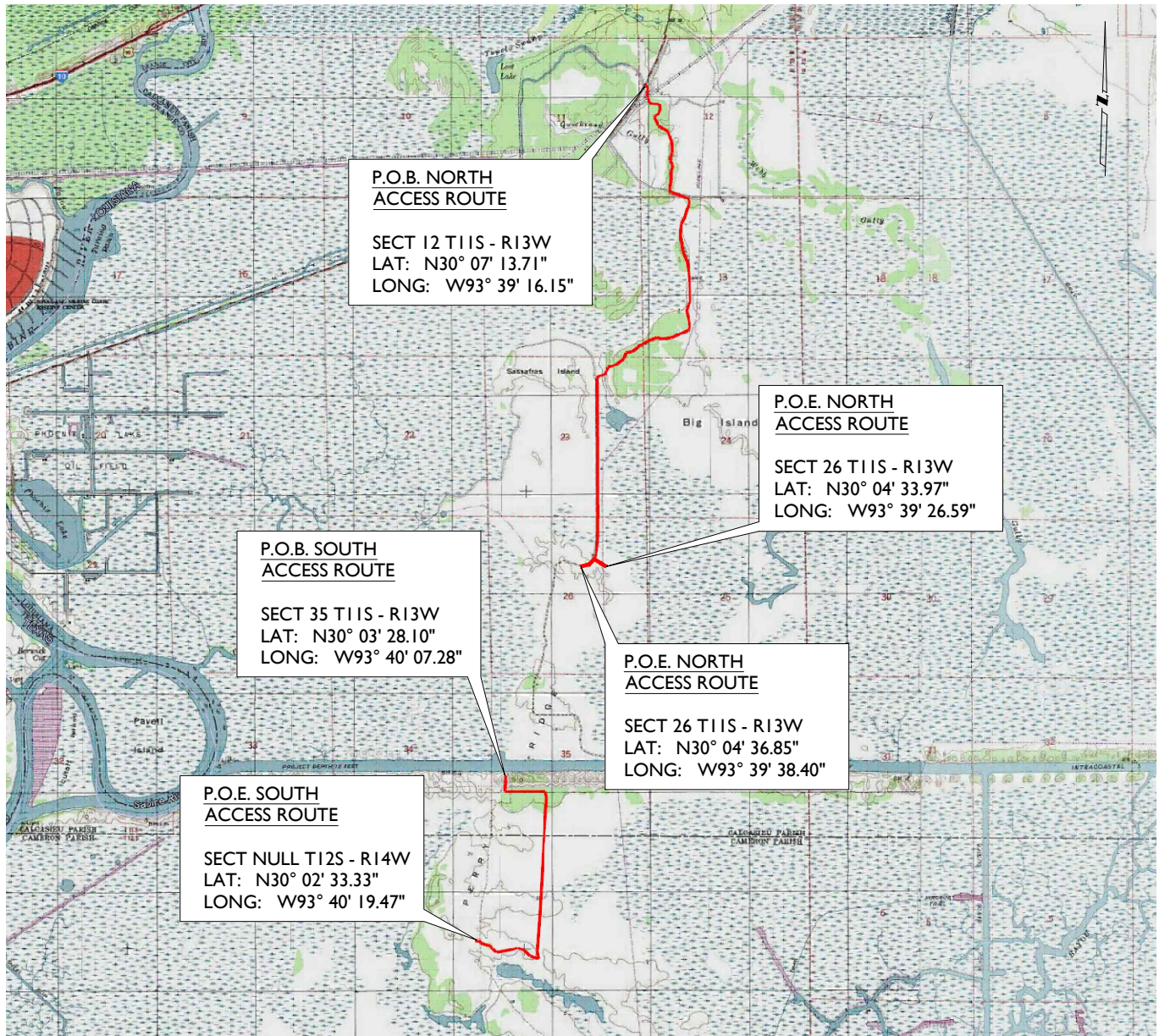

SCALE



PREPARED BY:

K&M PROJECT SERVICES, LLC



K&M Project Services, LLC
1000 Country Club Road
Phone: (337) 508-2868

MINERVA WELL-SITE ACCESS ROUTES

CALCASIEU PARISH, LOUISIANA
CAMERON PARISH, LOUISIANA

APPLICATION BY: Tetra Tech
PROJECT NO.: 2023-046

VICINITY MAP

SCALE: AS SHOWN

DATE: 08/11/2023

DRAWN BY: BML

02
16

Figure 1: Site Location
GCS, Calcasieu and Cameron Parishes, LA



Legend

-  Project Boundary
-  Cities
-  Interstate
-  US Highway

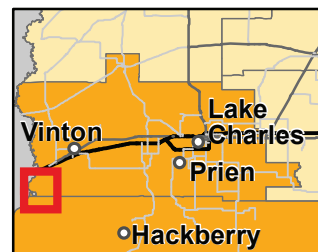
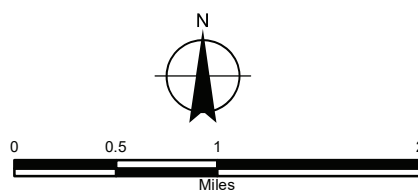

NOTE: THESE DRAWINGS ARE TO BE USED EXCLUSIVELY FOR ACQUISITION OF REGULATORY PERMITS.

REVISED: 10/27/2023 03/10/2025
11/15/2023 04/11/2025
01/15/2025



PREPARED BY:
K&M PROJECT SERVICES, LLC



K&M Project Services, LLC
1000 Country Club Road
Phone: (337) 508-2868

MINERVA WELL-SITE ACCESS ROUTES
CALCASIEU PARISH, LOUISIANA
CAMERON PARISH, LOUISIANA

APPLICATION BY: Tetra Tech
PROJECT NO.: 2023-046

**MINERVA NORTH CCS WELL
NO. 001 (LAY DOWN)**

SCALE:	AS SHOWN
DATE:	08/11/2023
DRAWN BY:	BML

03
16

NOTE: THESE DRAWINGS ARE TO BE USED EXCLUSIVELY FOR ACQUISITION OF REGULATORY PERMITS.

REVISED: 10/27/2023 03/10/2025
11/15/2023 04/11/2025
01/15/2025



SCALE



PREPARED BY:

K&M PROJECT SERVICES, LLC



K&M Project Services, LLC
1000 Country Club Road
Phone: (337) 508-2868

MINERVA WELL-SITE ACCESS ROUTES

CALCASIEU PARISH, LOUISIANA
CAMERON PARISH, LOUISIANA

APPLICATION BY: Tetra Tech
PROJECT NO.: 2023-046

FACILITY PAD

SCALE:	AS SHOWN
DATE:	08/11/2023
DRAWN BY:	BML

04 / 16

NOTE: THESE DRAWINGS ARE TO BE USED EXCLUSIVELY FOR ACQUISITION OF REGULATORY PERMITS.

REVISED: 10/27/2023 03/10/2025
11/15/2023 04/11/2025
01/15/2025



SCALE



PREPARED BY:

K&M PROJECT SERVICES, LLC



K&M Project Services, LLC
1000 Country Club Road
Phone: (337) 508-2868

MINERVA WELL-SITE ACCESS ROUTES

CALCASIEU PARISH, LOUISIANA
CAMERON PARISH, LOUISIANA

APPLICATION BY: Tetra Tech
PROJECT NO.: 2023-046

SOUTH ISLAND SITE

SCALE: AS SHOWN

DATE: 08/11/2023

DRAWN BY: BML

05
16

NOTE: THESE DRAWINGS ARE TO BE USED EXCLUSIVELY FOR ACQUISITION OF REGULATORY PERMITS.

REVISED: 10/27/2023 03/10/2025
11/15/2023 04/11/2025
01/15/2025

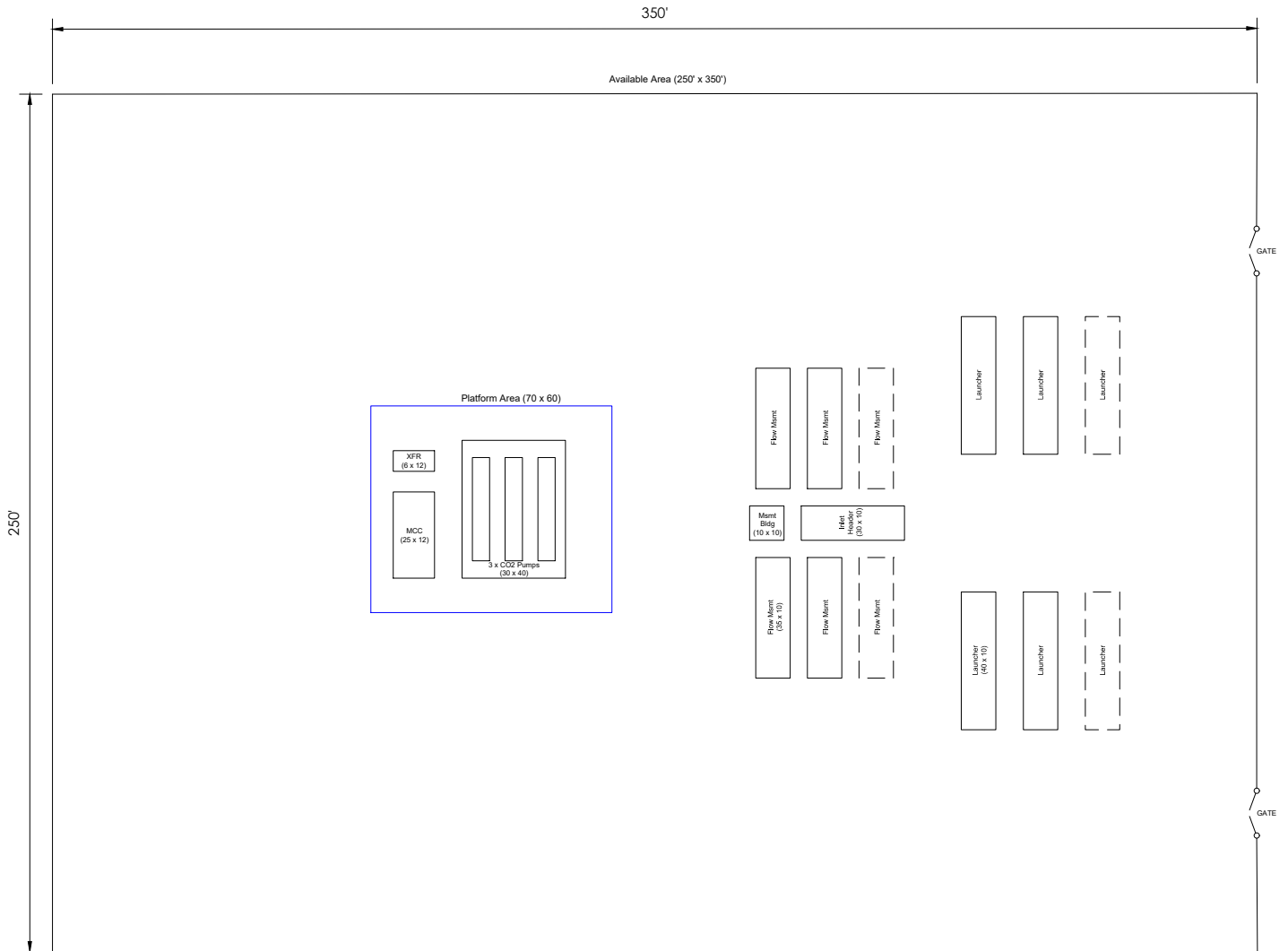

DRAWING A1

SCALE



PREPARED BY:
K&M PROJECT SERVICES, LLC



K&M Project Services, LLC
1000 Country Club Road
Phone: (337) 508-2868

MINERVA WELL-SITE ACCESS ROUTES
CALCASIEU PARISH, LOUISIANA
CAMERON PARISH, LOUISIANA

APPLICATION BY: Tetra Tech
PROJECT NO.: 2023-046

**NORTH WELL SITE
LAYOUT**

SCALE: AS SHOWN
DATE: 08/11/2023
DRAWN BY: BML

06
16

NOTE: THESE DRAWINGS ARE TO BE USED EXCLUSIVELY FOR ACQUISITION OF REGULATORY PERMITS.

REVISED: 10/27/2023 03/10/2025
11/15/2023 04/11/2025
01/15/2025

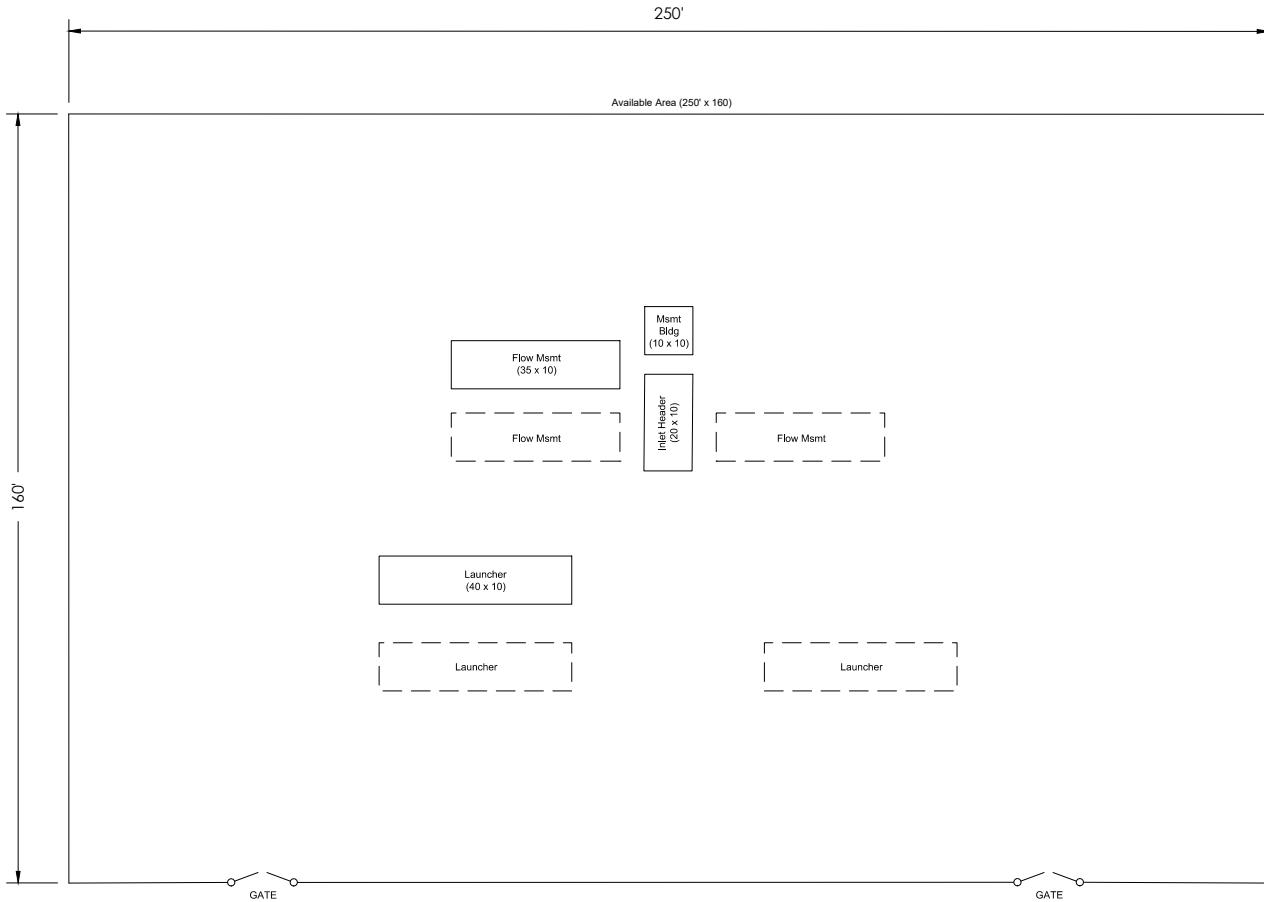

DRAWING C1

SCALE



PREPARED BY:

K&M PROJECT SERVICES, LLC



K&M Project Services, LLC
1000 Country Club Road
Phone: (337) 508-2868

MINERVA WELL-SITE ACCESS ROUTES

CALCASIEU PARISH, LOUISIANA
CAMERON PARISH, LOUISIANA

APPLICATION BY: Tetra Tech
PROJECT NO.: 2023-046

FACILITY PAD LAYOUT

SCALE: AS SHOWN

DATE: 08/11/2023

DRAWN BY: BML

07
16

NOTE: THESE DRAWINGS ARE TO BE USED EXCLUSIVELY FOR ACQUISITION OF REGULATORY PERMITS.

REVISED: 10/27/2023 03/10/2025
11/15/2023 04/11/2025
01/15/2025

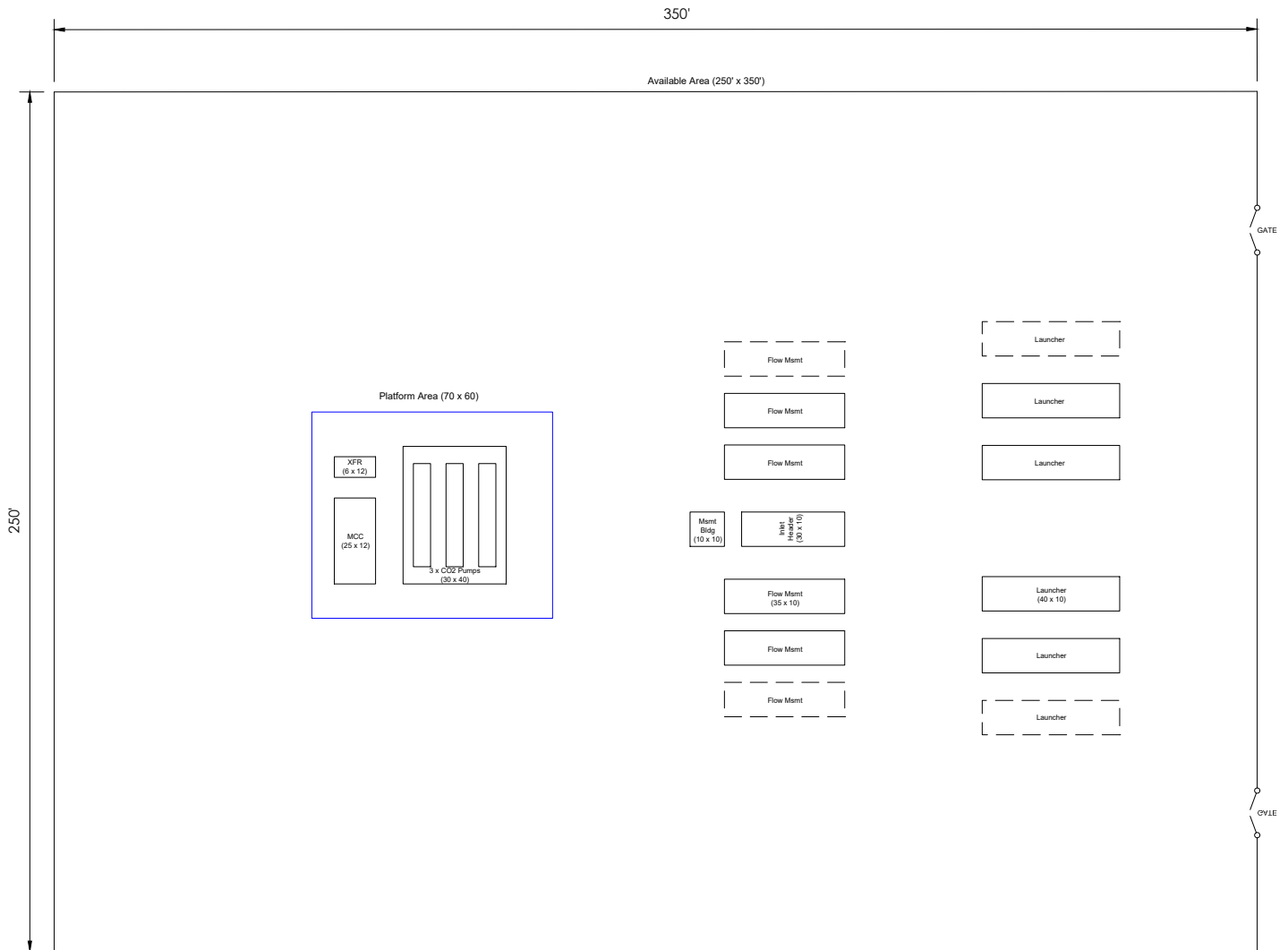

DRAWING A2

SCALE



PREPARED BY:

K&M PROJECT SERVICES, LLC



K&M Project Services, LLC
1000 Country Club Road
Phone: (337) 508-2868

MINERVA WELL-SITE ACCESS ROUTES

CALCASIEU PARISH, LOUISIANA
CAMERON PARISH, LOUISIANA

APPLICATION BY: Tetra Tech
PROJECT NO.: 2023-046

SOUTH ISLAND SITE LAYOUT

SCALE: AS SHOWN

DATE: 08/11/2023

DRAWN BY: BML

08/16

NOTE: THESE DRAWINGS ARE TO BE USED EXCLUSIVELY FOR ACQUISITION OF REGULATORY PERMITS.

REVISED: 10/27/2023 03/10/2025
11/15/2023 04/11/2025
01/15/2025

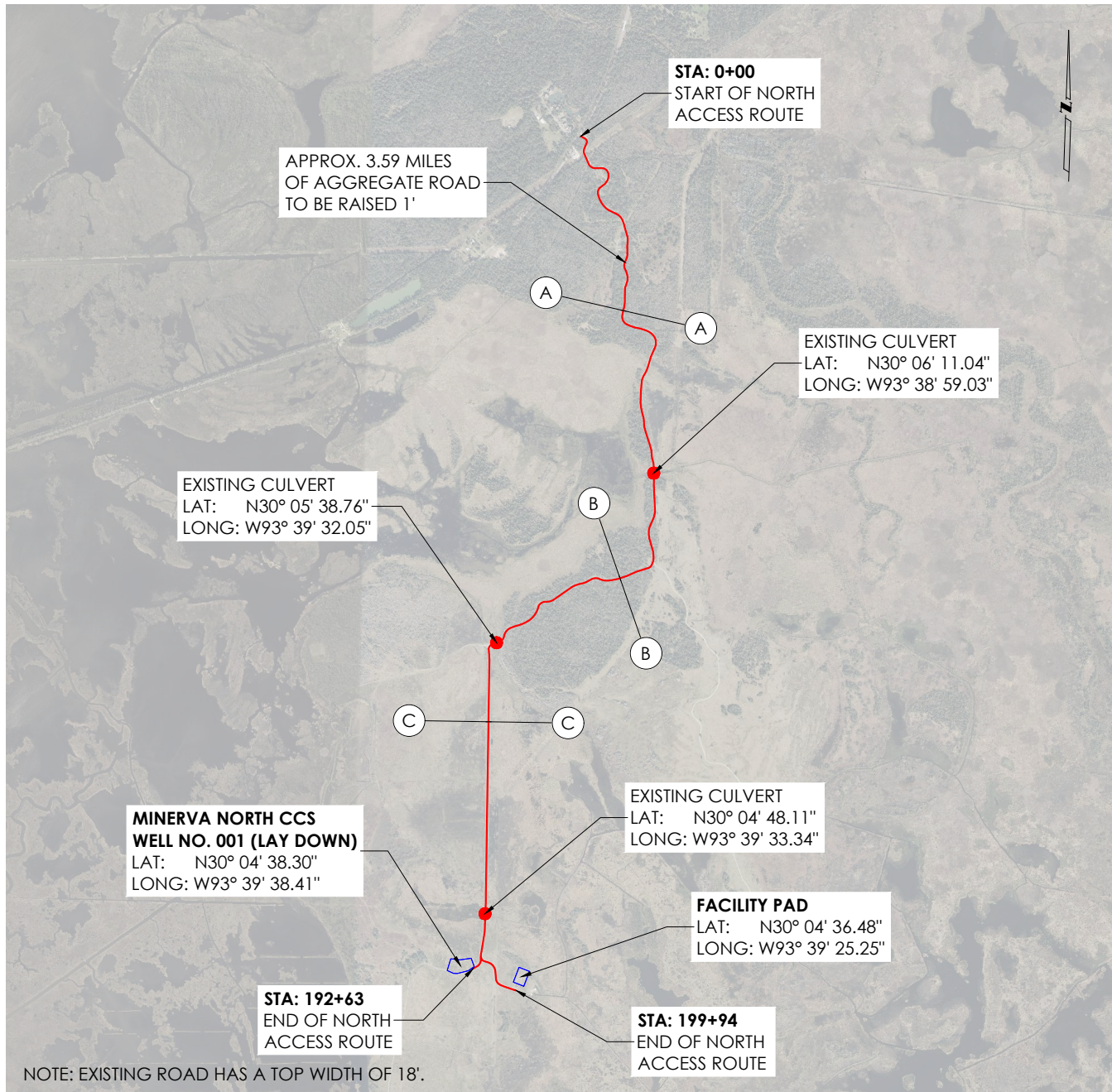

PREPARED BY:

K&M PROJECT SERVICES, LLC



K&M Project Services, LLC
1000 Country Club Road
Phone: (337) 508-2868

MINERVA WELL-SITE ACCESS ROUTES

CALCASIEU PARISH, LOUISIANA
CAMERON PARISH, LOUISIANA

APPLICATION BY: Tetra Tech
PROJECT NO.: 2023-046

N ROUTE PLAN VIEW

SCALE: AS SHOWN

DATE: 08/11/2023

DRAWN BY: BML

09
16

NOTE: THESE DRAWINGS ARE TO BE USED EXCLUSIVELY FOR ACQUISITION OF REGULATORY PERMITS.

REVISED: 10/27/2023 03/10/2025
11/15/2023 04/11/2025
01/15/2025

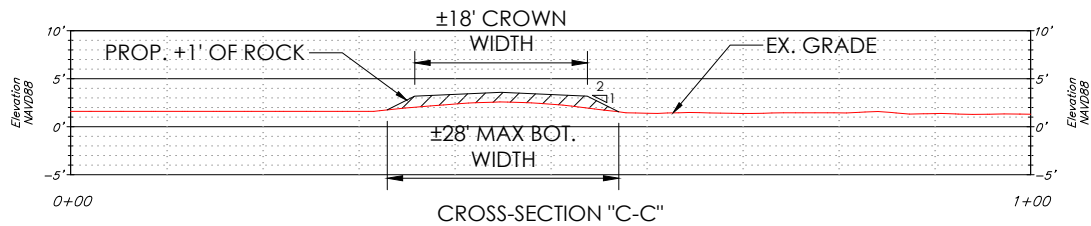
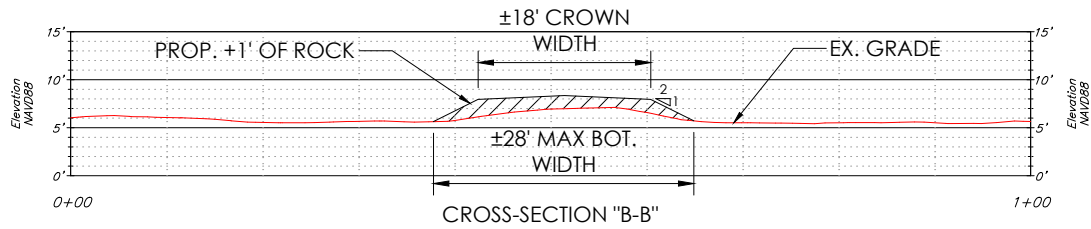
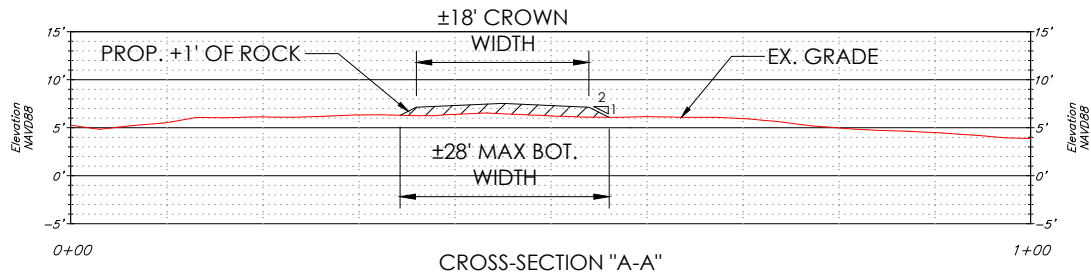

SCALE



PREPARED BY:
K&M PROJECT SERVICES, LLC



K&M Project Services, LLC
1000 Country Club Road
Phone: (337) 508-2868

MINERVA WELL-SITE ACCESS ROUTES
CALCASIEU PARISH, LOUISIANA
CAMERON PARISH, LOUISIANA

APPLICATION BY: Tetra Tech
PROJECT NO.: 2023-046

N ROUTE SECTION VIEWS

SCALE: AS SHOWN
DATE: 08/11/2023
DRAWN BY: BML

10
16

NOTE: THESE DRAWINGS ARE TO BE USED EXCLUSIVELY FOR ACQUISITION OF REGULATORY PERMITS.

REVISED: 10/27/2023 03/10/2025
11/15/2023 04/11/2025
01/15/2025

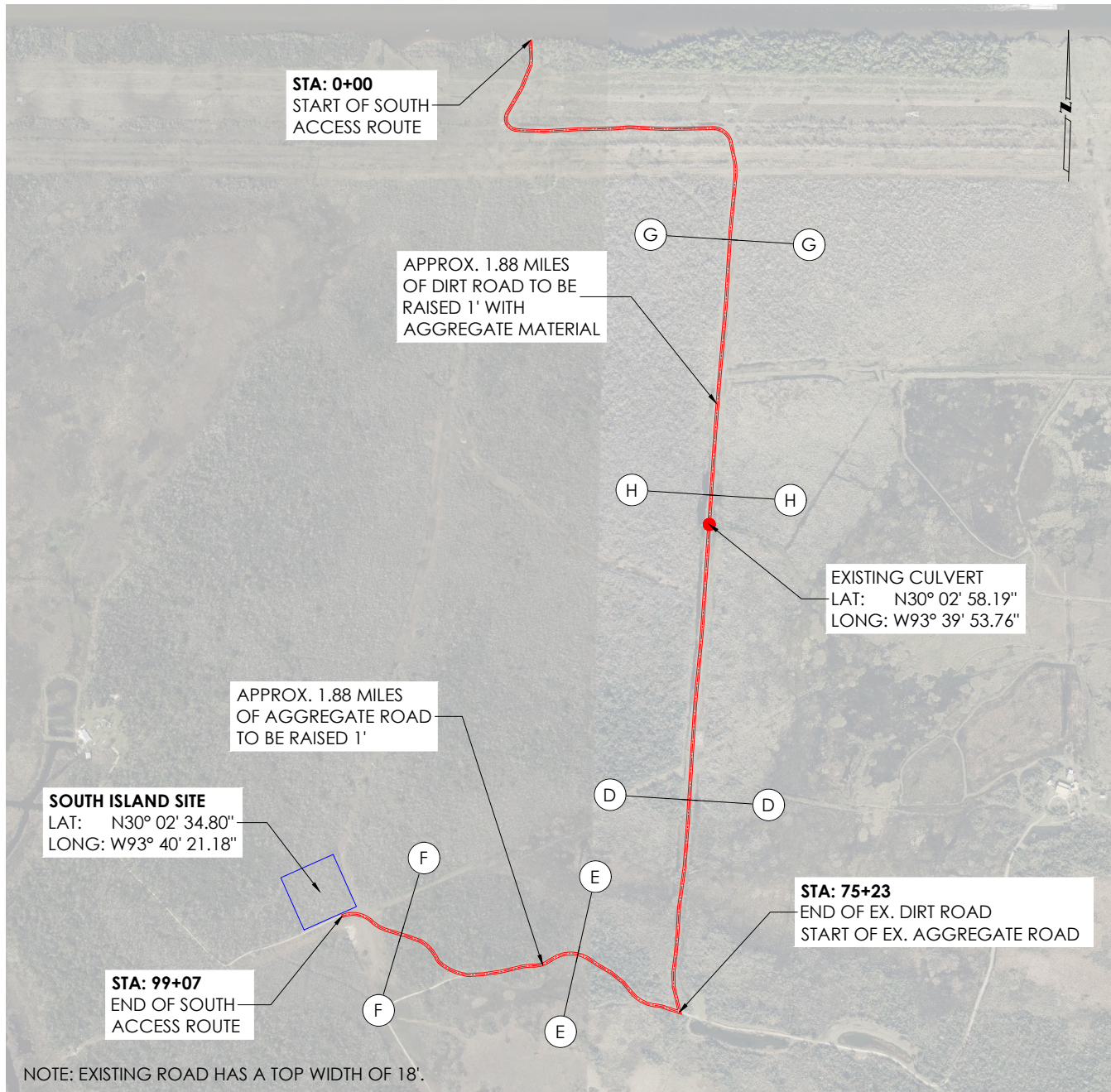

SCALE



PREPARED BY:

K&M PROJECT SERVICES, LLC



K&M Project Services, LLC
1000 Country Club Road
Phone: (337) 508-2868

MINERVA WELL-SITE ACCESS ROUTES

CALCASIEU PARISH, LOUISIANA
CAMERON PARISH, LOUISIANA

APPLICATION BY: Tetra Tech
PROJECT NO.: 2023-046

S ROUTE PLAN VIEW

SCALE: AS SHOWN

DATE: 08/11/2023

DRAWN BY: BML

11
16

NOTE: THESE DRAWINGS ARE TO BE USED EXCLUSIVELY FOR ACQUISITION OF REGULATORY PERMITS.

REVISED: 10/27/2023 03/10/2025
11/15/2023 04/11/2025
01/15/2025

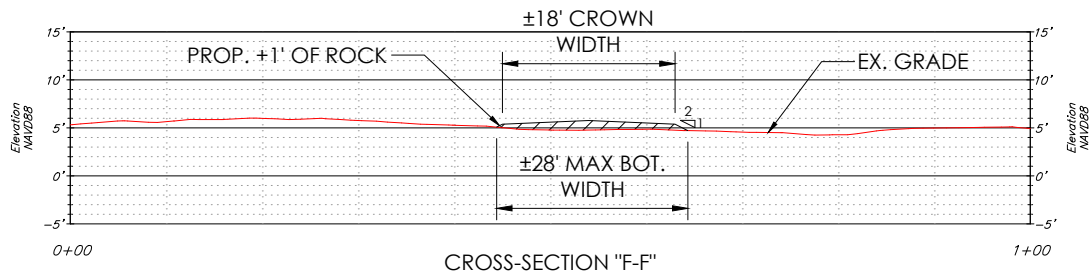
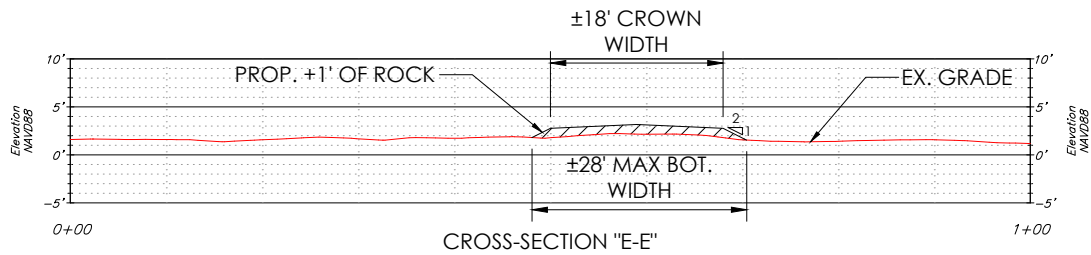
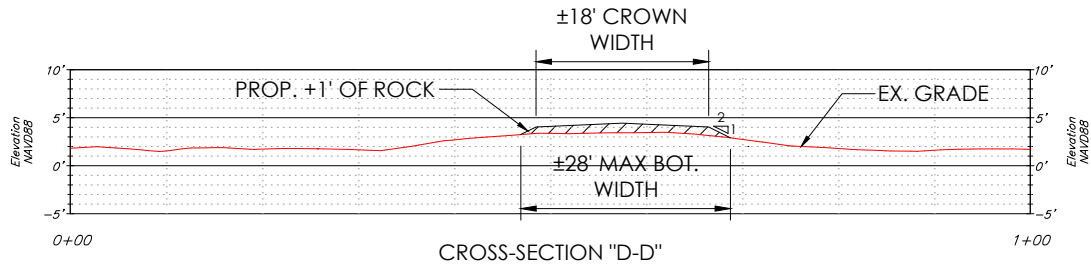

SCALE



PREPARED BY:

K&M PROJECT SERVICES, LLC



K&M Project Services, LLC
1000 Country Club Road
Phone: (337) 508-2868

MINERVA WELL-SITE ACCESS ROUTES

CALCASIEU PARISH, LOUISIANA
CAMERON PARISH, LOUISIANA

APPLICATION BY: Tetra Tech
PROJECT NO.: 2023-046

S ROUTE SECTION VIEWS

SCALE: AS SHOWN

DATE: 08/11/2023

DRAWN BY: BML

12 / 16

NOTE: THESE DRAWINGS ARE TO BE USED EXCLUSIVELY FOR ACQUISITION OF REGULATORY PERMITS.

REVISED: 10/27/2023 03/10/2025
11/15/2023 04/11/2025
01/15/2025

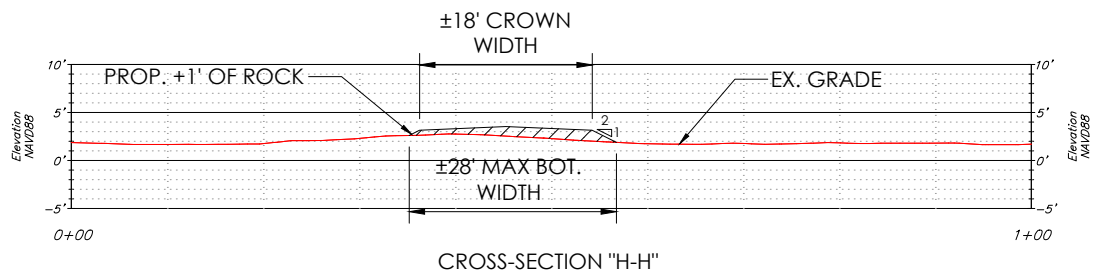
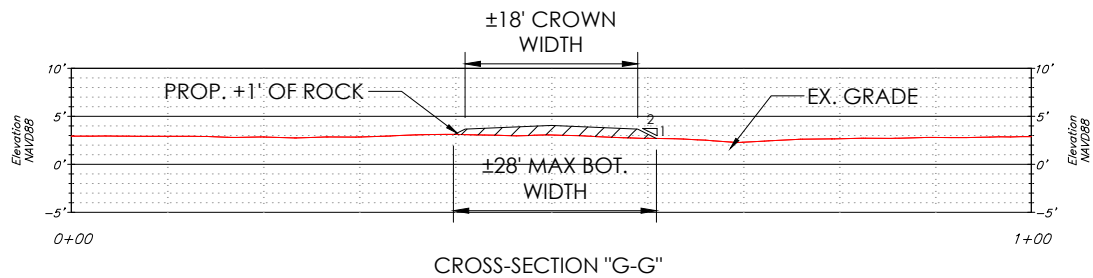

SCALE



PREPARED BY:

K&M PROJECT SERVICES, LLC



K&M Project Services, LLC
1000 Country Club Road
Phone: (337) 508-2868

MINERVA WELL-SITE ACCESS ROUTES

CALCASIEU PARISH, LOUISIANA
CAMERON PARISH, LOUISIANA

APPLICATION BY: Tetra Tech
PROJECT NO.: 2023-046

S ROUTE SECTION VIEWS

SCALE: AS SHOWN

DATE: 08/11/2023

DRAWN BY: BML

13
16

NOTE: THESE DRAWINGS ARE TO BE USED EXCLUSIVELY FOR ACQUISITION OF REGULATORY PERMITS.

REVISED: 10/27/2023 03/10/2025
11/15/2023 04/11/2025
01/15/2025

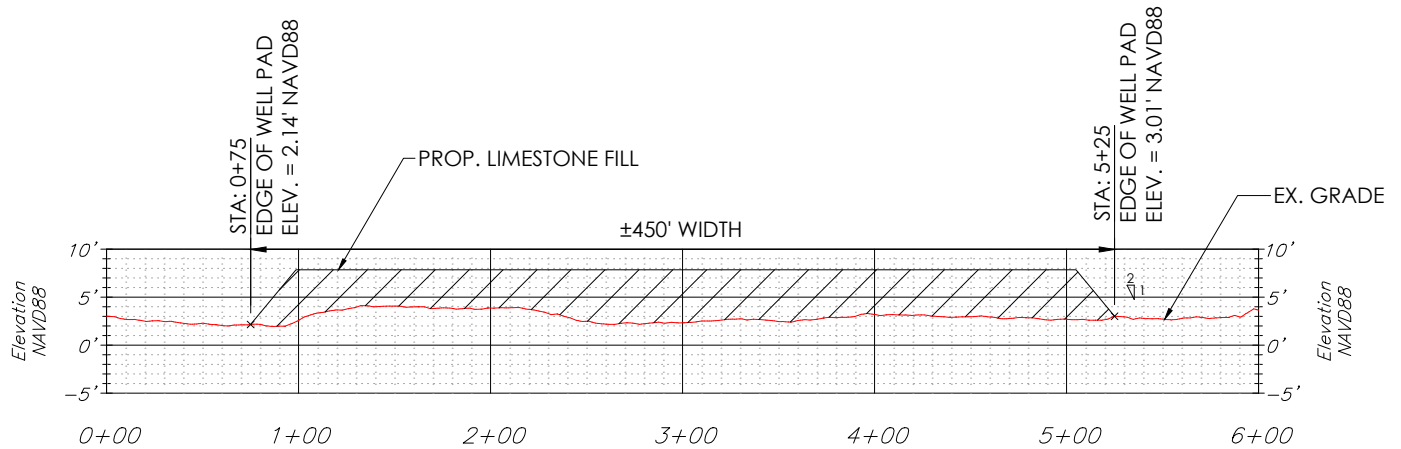

CROSS-SECTION "A-A"
"MINERVA NORTH CCS
WELL NO. 001 (LAY DOWN)"

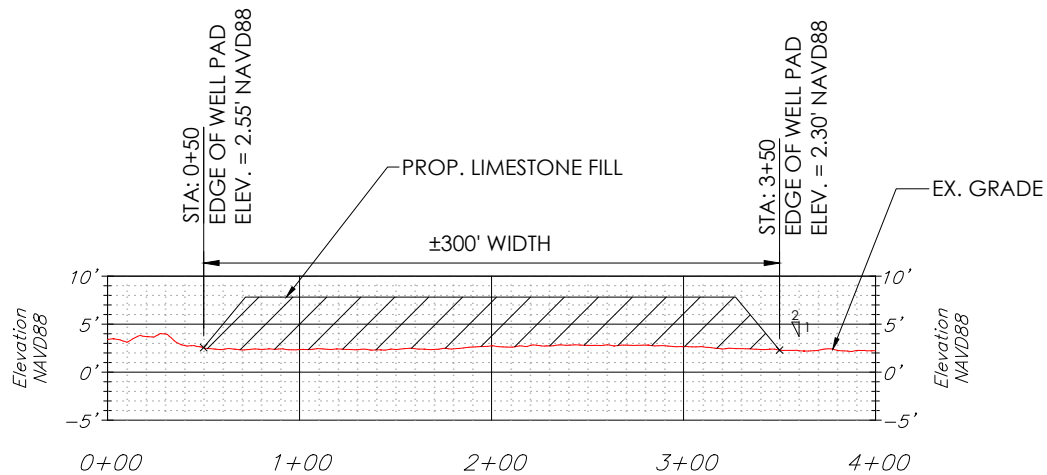

CROSS-SECTION "B-B"
"FACILITY PAD"

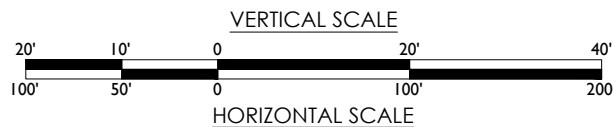

PREPARED BY:

K&M PROJECT SERVICES, LLC



K&M Project Services, LLC
1000 Country Club Road
Phone: (337) 508-2868

MINERVA WELL-SITE ACCESS ROUTES

CALCASIEU PARISH, LOUISIANA
CAMERON PARISH, LOUISIANA

APPLICATION BY: Tetra Tech
PROJECT NO.: 2023-046

WELL PAD SECTION VIEWS

SCALE: AS SHOWN

DATE: 08/11/2023

DRAWN BY: BML

14
16

NOTE: THESE DRAWINGS ARE TO BE USED EXCLUSIVELY FOR ACQUISITION OF REGULATORY PERMITS.

REVISED: 10/27/2023 03/10/2025
11/15/2023 04/11/2025
01/15/2025

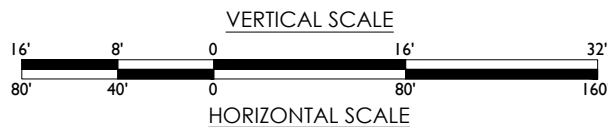
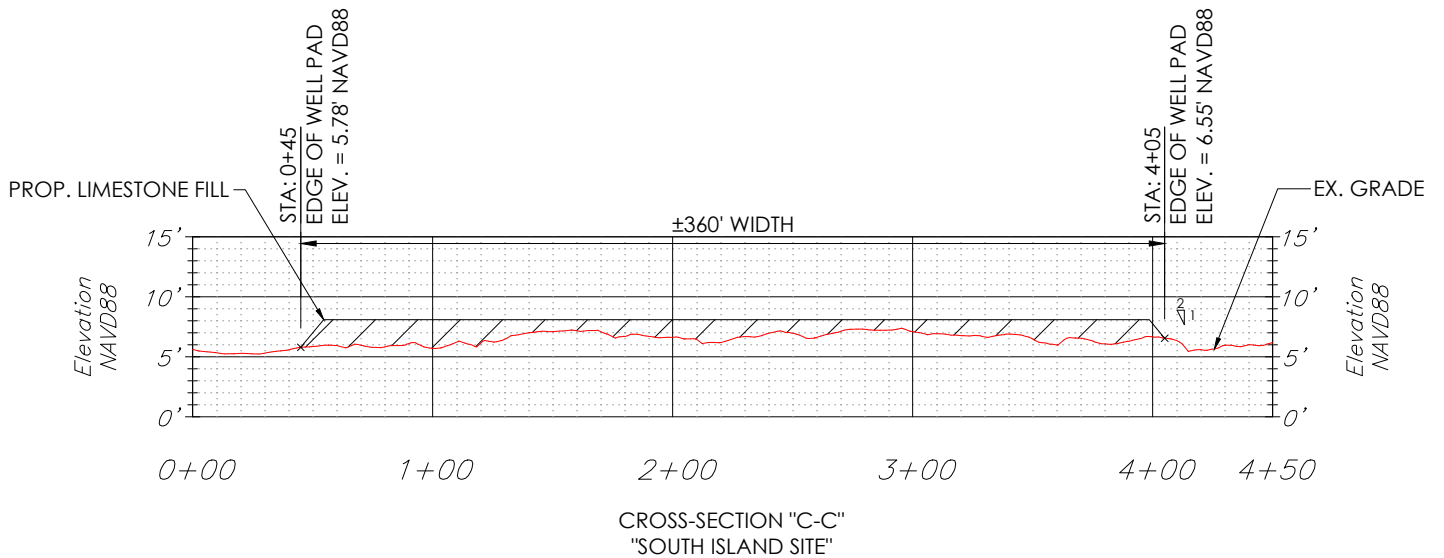

PREPARED BY:

K&M PROJECT SERVICES, LLC



K&M Project Services, LLC
1000 Country Club Road
Phone: (337) 508-2868

MINERVA WELL-SITE ACCESS ROUTES

CALCASIEU PARISH, LOUISIANA
CAMERON PARISH, LOUISIANA

APPLICATION BY: Tetra Tech
PROJECT NO.: 2023-046

WELL PAD SECTION VIEWS

SCALE: AS SHOWN

DATE: 08/11/2023

DRAWN BY: BML

15
16

NOTE: THESE DRAWINGS ARE TO BE USED EXCLUSIVELY FOR ACQUISITION OF REGULATORY PERMITS.

REVISED: 10/27/2023 03/10/2025
11/15/2023 04/11/2025
01/15/2025

GENERAL NOTES:

1. EQUIPMENT (GRADERS, EXCAVATORS, ETC.) AND MATERIALS (SUCH AS GROUND SHEETS, HAY BALES, BOOMS, AND ABSORBENT PADS) FOR CLEANUP AND CONTINGENCIES SHALL BE PROVIDED IN SUFFICIENT QUANTITIES BY THE CONTRACTOR AND MAINTAINED AT ALL SITES FOR USE IN THE EVENT OF INADVERTENT LEAKS, SEEPS, OR SPILLS. WASTE DRILLING MUD AND CUTTINGS SHALL BE DEWATERED, DRIED, AND STOCK PILED SUCH THAT IT CAN BE LOADED BY EQUIPMENT, TRANSFERRED TO A TRUCK AND HAULED OFFSITE TO A SUITABLE LEGAL DISPOSAL SITE. THE MAXIMUM ALLOWED WATER CONTENT OF THESE SOLIDS IS 50% OF WEIGHT.
2. WELLS AT SITES SHOWN IN THESE DRAWINGS SHALL BE CLOSED MUD SYSTEMS.
3. THESE PLANS ARE INTENDED EXCLUSIVELY FOR THE PURPOSE OF OBTAINING ENVIRONMENTAL COMPLIANCE PERMITS AND ARE NOT TO BE USED FOR CONSTRUCTION, BIDDING, RECORDATION, CONVEYANCE, SALES OR ENGINEERING DESIGN.
4. AT THIS TIME, K & M PROJECT SERVICES, L.L.C. HAS NOT PERFORMED NOR WAS ASKED TO PERFORM ANY TYPE OF SURVEYING, ENGINEERING, HYDROLOGICAL MODELING, FLOOD PLAIN, OR "NO-RISE" CERTIFICATION ANALYSES, INCLUDING BUT NOT LIMITED TO DETERMINING WHETHER THE PROJECT WILL IMPACT FLOOD HAZARDS IN CONNECTION WITH FEDERAL/FEMA, STATE, AND/OR LOCAL LAWS, ORDINANCES, AND REGULATIONS. ACCORDINGLY, K & M MAKES NO WARRANTY OR REPRESENTATION OF ANY KIND AS TO THE FOREGOING ISSUES, AND PERSONS OR ENTITIES USING THIS INFORMATION SHALL DO SO AT THEIR OWN RISK.
5. IN ORDER TO ENSURE THE SAFETY OF ALL PARTIES, THE PERMITEE WILL CONTACT THE LOUISIANA ONE CALL SYSTEM (1-800-272-3020) A MINIMUM OF 48 HOURS PRIOR TO COMMENCEMENT OF ANY EXCAVATION (DIGGING, DREDGING, JETTING, ETC.) OR DEMOLITION ACTIVITY.
6. THE CONTRACTOR SHALL CONTACT LOUISIANA ONE CALL AT 811 FOR UTILITY LOCATIONS.
7. THE CONTRACTOR SHALL HAVE SOMEONE AVAILABLE TO RECEIVE CALLS AND DISPATCH PROPER PERSONNEL AND EQUIPMENT ON A TWENTY-FOUR (24) HOUR BASIS FOR EMERGENCIES.
8. THE CONTRACTOR IS ADVISED THAT EXISTING OVERHEAD AND UNDERGROUND UTILITIES SUCH AS (BUT NOT LIMITED TO) ELECTRICAL LINES AND POLES, TELEPHONE CABLES, TELEVISION CABLES, GAS LINES, WATER LINES, AND SANITARY SEWER LINES/FORCE MAINS MAY EXIST WHERE THE PROPOSED IMPROVEMENTS ARE REQUIRED. UTILITY SIZE, DEPTH, & HORIZONTAL LOCATION SHOWN ON THE PLANS ARE APPROXIMATE (NOT SCALABLE). UTILITIES SHOWN DO NOT INCLUDE SERVICE LOCATIONS AND THERE IS NO EXPRESSED OR IMPLIED GUARANTEE OF THE ACCURACY OF THOSE UTILITIES OR OMISSIONS. THE CONTRACTOR SHALL BE SOLELY RESPONSIBLE FOR LOCATING AND PROTECTING EXISTING UTILITIES DURING THE PERFORMANCE OF WORK TO BE INSTALLED UNDER THIS CONTRACT. THE CONTRACTOR SHALL VERIFY ALL UTILITY LOCATIONS PRIOR TO COMMENCEMENT OF CONSTRUCTION WORK.
9. ALL SERVICES DAMAGED BY THE CONTRACTOR SHALL BE REPAIRED WITHIN THE SAME WORK DAY WITHOUT EXCEPTION AT NO ADDITIONAL COST TO THE OWNER.
10. ACCESS ROUTES ARE IMPROVEMENTS TO EXISTING ROADS. NO ADDITIONAL DRAINAGE FEATURES OR CULVERTS ARE NEEDED. NO DRAINAGE FEATURES OR CULVERTS NEED IMPROVEMENT.
11. As-built drawings and/or plats shall have written on them the date of completion of said activities and shall be submitted to the Louisiana Department of Energy and Natural Resources, Office of Coastal Management, P. O. Box 44487, Baton Rouge, LA 70804-4487 within 30 days following project completion.
12. All structures built under the authorization and conditions of this permit shall be removed from the site within 120 days of abandonment of the facilities for the herein permitted use, or when these structures fall into a state of disrepair such that they can no longer function as intended. This condition does not preclude the necessity for revising the current permit or obtaining a separate Coastal Use Permit, should one be required, for such removal activities.
13. Structures must also be marked/lighted in accordance with U. S. Coast Guard regulations.
14. In order to ensure the safety of all parties, the permittee shall contact the Louisiana One Call System (1-800-272-3020) a minimum of 48 hours prior to the commencement of any excavation (digging, dredging, jetting, etc.) or demolition activity.

PREPARED BY:

K&M PROJECT SERVICES, LLC



K&M Project Services, LLC
1000 Country Club Road
Phone: (337) 508-2868

MINERVA WELL-SITE ACCESS ROUTES

CALCASIEU PARISH, LOUISIANA
CAMERON PARISH, LOUISIANA

APPLICATION BY: Tetra Tech
PROJECT NO.: 2023-046

GENERAL NOTES

SCALE: AS SHOWN

DATE: 08/11/2023

DRAWN BY: BML

16
16

DESIGNATION	NAD 27 LA SOUTH ZONE (1702)	NAD 27 LAT/LONG	NAD 83 LA SOUTH ZONE (1702)	NAD 83 LAT/LONG
MINERVA NORTH CCS WELL NO. 001	N 520372.86	N 30° 04' 37.58"	N 581085.05	N 30° 04' 38.34"
	E 1263953.93	W 93° 39' 38.13"	E 2544752.02	W 93° 39' 38.72"
MINERVA NORTH CCS WELL NO. 002	N 30° 04' 377.58"	N 520372.86	N 581085.05	N 30° 04' 38.34"
	W 93° 39' 37.90"	E 1263973.93	E 2544772.02	W 93° 39' 38.49"
MINERVA SOUTH CCS WELL NO. 001	N 507978.59	N 30° 02' 34.10"	N 568690.65	N 30° 02' 34.87"
	E 1259965.87	W 93° 40' 20.63"	E 2540763.87	W 93° 40' 21.22"
MINERVA SOUTH CCS WELL NO. 002	N 507951.32	N 30° 02' 33.84"	N 568663.38	N 30° 02' 34.60"
	E 1259978.31	W 93° 40' 20.48"	E 2540776.30	W 93° 40' 21.07"